

# Active+ Sense

ROCKGATE

The Active+ Sense is a small luminaire-based sensor that combines a light sensor for constant light control and a passive infrared movement detector

This sensor can be used on the intelligent luminaire stand-alone control solution Active+.

The Active+ Sense plugs in the Active+ LED driver for Active+ usage.

If the sensor is connected to non-SELV control gear, the luminaire must be Class I.

## Key Features

- Small and inconspicuous, it does not change the appearance of the luminaire.
- Provided with mounting features that can be snapped into sheet metal: two on each long side, and two on the rear.

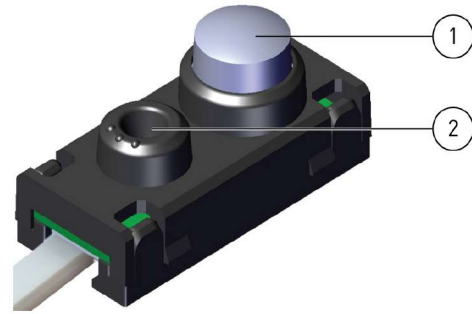

1. PIR sensor
2. Light sensor

## Mounting Features

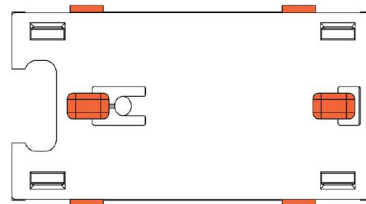
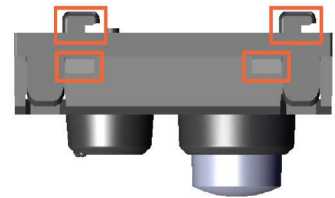

## Light Sensor - For constant light functions

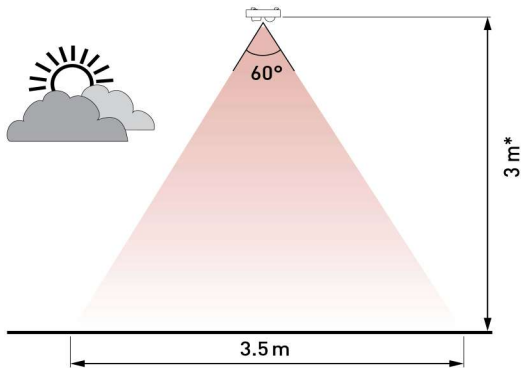

\* Max recommended height 3 m

## Presence Detector - Passive infrared (PIR)

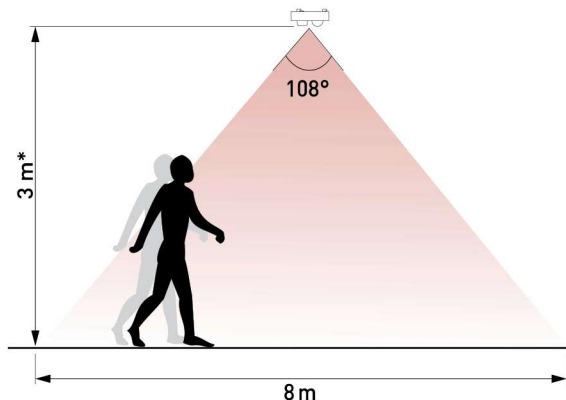

\* Max recommended height 4 m

## Detection pattern at floor level for 2.5 meters mounting height

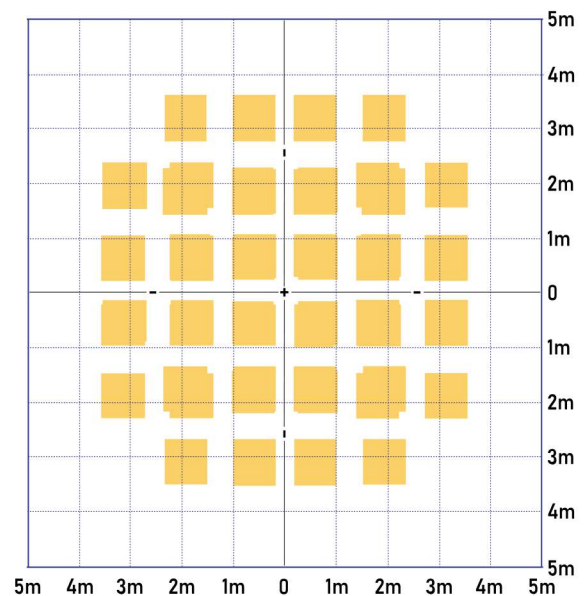



| Connections |  |
|-------------|--|
| Active+:    | Flexible cable terminated with a fourway, 2 mm keyed connector   |
|             |  Note: If the sensor is connected to nonSELV control gear, the luminaire must be Class I. |

| Mechanical data |                       |
|-----------------|-----------------------|
| Dimensions:     | 50 mm × 20 mm × 10 mm |
| Weight:         | 12 g                  |
| IP rating:      | IP20                  |

| Cable information   |                              |
|---------------------|------------------------------|
| Order Code: 3021010 | Length: 80 cm, Colour: White |

| Operating and storage conditions |   |
|----------------------------------|---|
| Ambient temperature:             | -20 °C to +50 °C  |
|                                  |  Note: The temperature difference between the detection target and the background must be at least 4 °C. |
| Relative humidity:               | Max. 85 %, non-condensing   |
| Storage temperature:             | -20 °C to +70 °C  |
| Illuminance:                     | 5 lx to 5000 lx   |

| Conformity and standards |   |
|--------------------------|---|
| Conformity:              |   |
| EMC emission:            | EN 55015  |
| EMC immunity:            | EN 61547  |
| Safety:                  | EN 61347-2-11   |
| Environment:             | Complies with RoHS directive.   |

Connection

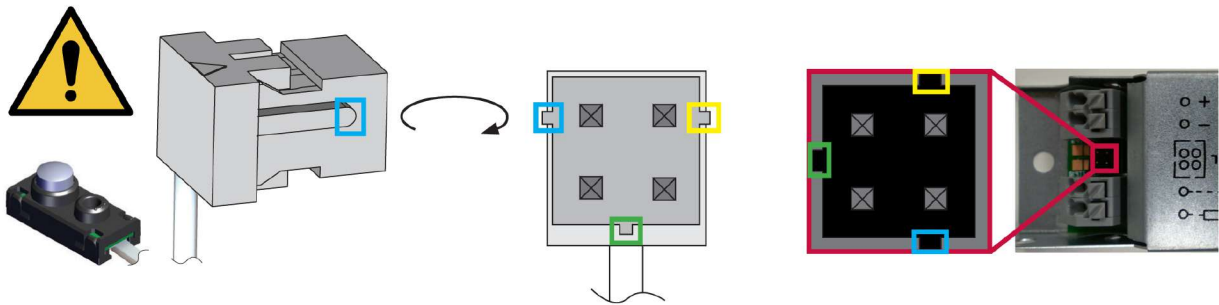

Dimensions (mm)

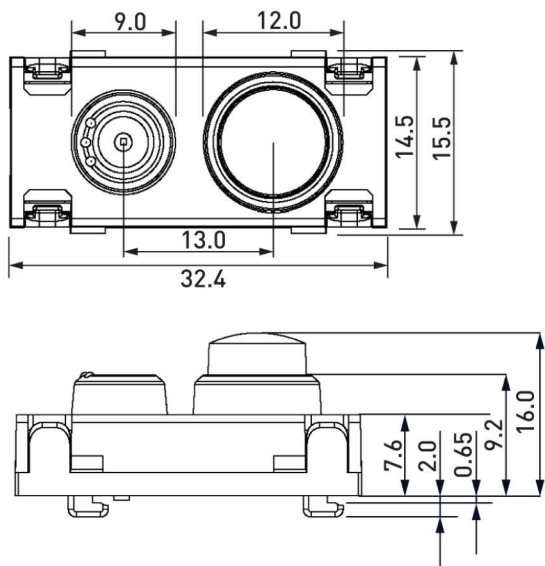

Mounting

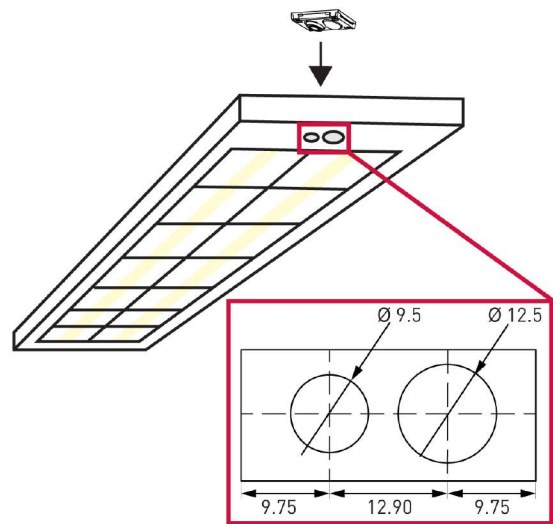

Note: Sensor holders are available to be used with the Active+ Sense:

5691 - ActiveAhead Sense Rectangular Sensor holder

5692 - ActiveAhead Sense Circular Sensor holder